



## About Warnings

 **WARNING:** A WARNING indicates a potential for property damage, personal injury, or death.

## Dell™ Precision™ Workstation T3500

### Setup and Features Information

#### Front View

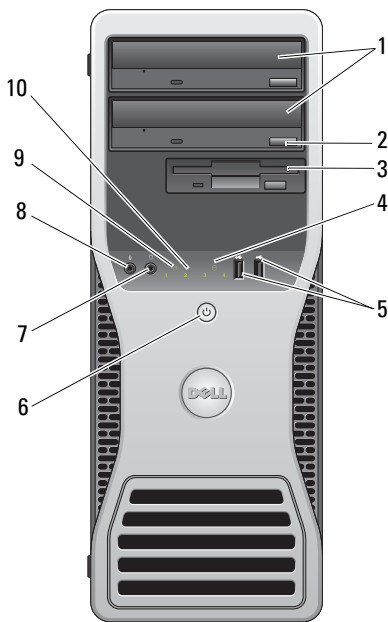

- |   |  |   |                            |
|---|--|---|----------------------------|
| 1 | optical drives (2)                                   | 2 | optical drive eject button |
| 3 | FlexBay (optional floppy drive or media card reader) | 4 | drive activity light       |



- 5 USB 2.0 connectors (2)
- 6 power button, power light
- 7 headphone connector
- 8 microphone connector
- 9 network link light
- 10 diagnostic lights (4)

## Back View

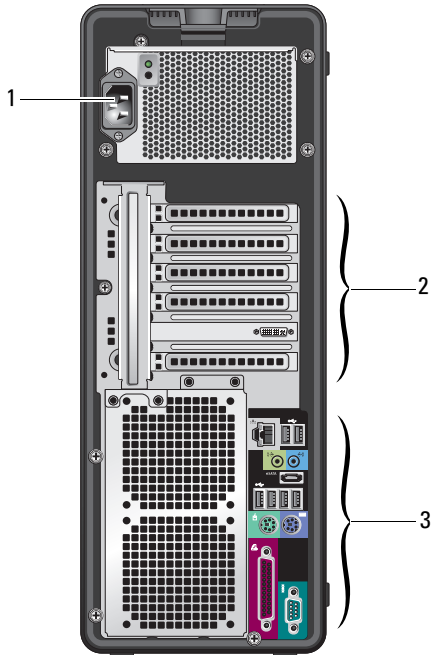

- 1 power connector
- 2 expansion card slots (6)
- 3 back panel connectors

## Back Panel Connectors

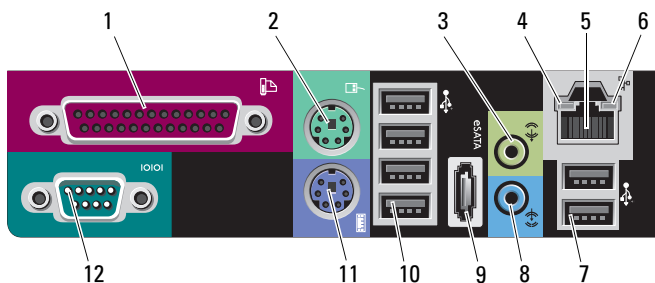

- |    |                           |    |                        |
|----|---------------------------|----|------------------------|
| 1  | parallel connector        | 2  | PS/2 mouse connector   |
| 3  | line-out connector        | 4  | link integrity light   |
| 5  | network adapter connector | 6  | network activity light |
| 7  | USB 2.0 connectors (2)    | 8  | line-in connector      |
| 9  | eSATA connector           | 10 | USB 2.0 connectors (4) |
| 11 | PS/2 keyboard connector   | 12 | serial connector       |

## Quick Setup



**WARNING:** Before you begin any of the procedures in this section, read the safety information that shipped with your computer. For additional best practices information see [www.dell.com/regulatory\\_compliance](http://www.dell.com/regulatory_compliance).



**NOTE:** Some devices may not be included if you did not order them.

1 Connect the monitor using one of the following cables:

**a** The dual monitor Y-adapter cable

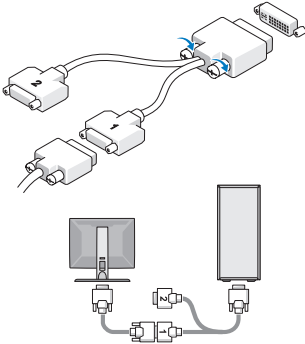

**b** The white DVI cable

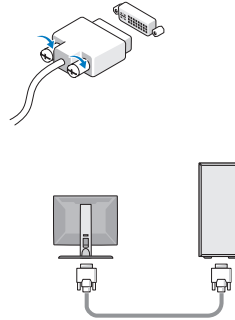

**c** The display port cable

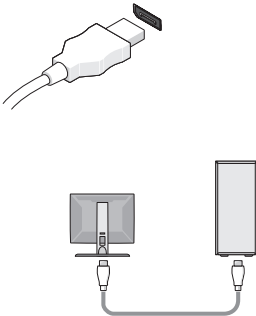

**d** The DVI to display port adapter

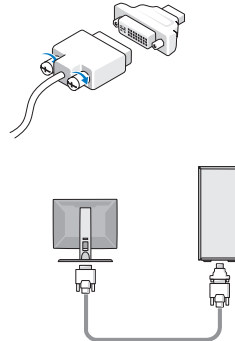

**2** Connect a USB device, such as a keyboard or mouse.

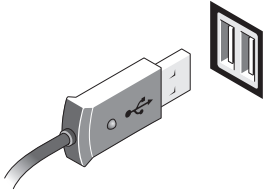
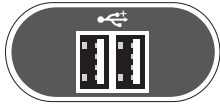

**3** Connect the network cable.

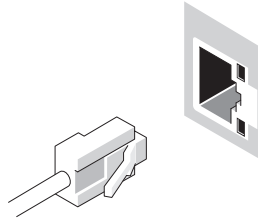
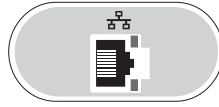

**4** Connect the power cable(s).

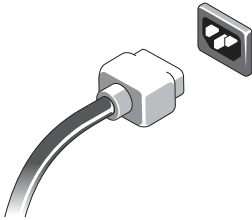
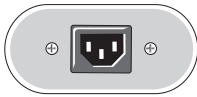

**5** Press the power buttons on the monitor and the computer.

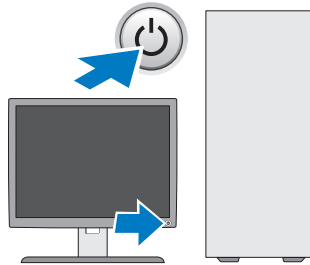

## Specifications



**NOTE:** The following specifications are only those required by law to ship with your computer. For a complete and current listing of the specifications for your computer, go to [support.dell.com](http://support.dell.com).

---

### Processor

---

Type	Intel® Xeon® Processor 3500 series Intel Xeon Processor 5500 series
------	--

---

### System Information

---

System chipset	Intel X58+ ICH10
Data bus width	64 bits

---

### Video

---

Type:	
Discrete	two PCI Express 2.0 x16 slots <b>NOTE:</b> Support for discrete full height and 3/4 length graphics option through PCIe x16 graphics card slot.

---

### Drives

---

Externally accessible	one 3.5-inch drive bay (FlexBay) two 5.25-inch drive bays
Internally accessible	two 3.5-inch SATA drive bays <b>NOTE:</b> The platform can accommodate third and fourth 3.5-inch hard drives in the flex bay or the optical drive bay.

---

### Controls and Lights

---

Front of the computer:

Power button	push button
Power light	amber light — Solid amber indicates a problem with an installed device; blinking amber indicates an internal power problem. green light — Blinking green in sleep state; solid green for power-on state.
Drive activity light	green light — A blinking green light indicates the computer is reading data from or writing data to the SATA hard drive or CD/DVD.

---

**Controls and Lights** *(continued)*

---

Network link light	green light — Solid green indicates connection to an active network off (no light) — System is not connected to a network
Rear of the computer:	
Link integrity light (on integrated network adapter)	link integrity light color is based on the link speed: green light — A good connection at 10Mbps exists between the network and the computer. orange light — A good connection at 100Mbps exists between the network and the computer. yellow light — A good connection at 1000Mbps exists between the network and the computer. off(no light) — The computer is not detecting a physical connection to the network.
Network activity light (on integrated network adapter)	yellow blinking light

---

**Power**

---

DC power supply:	
Voltage (see the safety information that shipped with your computer for important voltage setting information)	115/230 VAC, 50/60 Hz, 6.0/3.0 A
Coin-cell battery	3 V CR2032 lithium coin cell

---

**Physical**

---

Height	44.8 cm (17.6 inches)
Width	17.25 cm (6.8 inches)
Depth	46.8 cm (18.4 inches)
Weight	17.3 kg (38.0 lb)

---

**Environmental**

---

Temperature:

Operating 10° to 35° C (50° to 95° F)

Storage -40° to 65° C (-40° to 149° F)

Relative humidity 20% to 80% (noncondensing)

Altitude:

Operating -15.2 to 3048 m (-50 to 10,000 ft)

Storage -15.2 to 10,668 m (-50 to 35,000 ft)

Airborne contaminant level G2 or lower as defined by ISA-S71.04-1985

## Finding More Information and Resources

---

**If you need to:****See:**

---

Find safety best practices information for your computer, review Warranty information, Terms and Conditions(U.S only), Safety instructions, Regulatory information, Ergonomics information, and End User License Agreement.

The safety and regulatory documents that shipped with your computer and also see the Regulatory Compliance Homepage at **[www.dell.com/regulatory\\_compliance](http://www.dell.com/regulatory_compliance)**.

---

**Information in this document is subject to change without notice.**

**© 2009 Dell Inc. All rights reserved. Printed in the U.S.A.**

Reproduction of these materials in any manner whatsoever without the written permission of Dell Inc. is strictly forbidden.

Trademarks used in this text: *Dell*, the *DELL* logo, and *Dell Precision* are trademarks of Dell Inc.; *Intel* and *Xeon* are registered trademarks of Intel Corporation in the U.S. and other countries.

Other trademarks and trade names may be used in this document to refer to either the entities claiming the marks and names or their products. Dell Inc. disclaims any proprietary interest in trademarks and trade names other than its own.